



IMAGINE

DOWNTOWN CHELAN

Imagine Downtown Chelan

Configuration and demonstration survey responses to proposals as of 22 September

September 26, 2023 Open House - Zoom Recording
https://us02web.zoom.us/rec/share/Wabp9V-bM5cdK6UrzhXtXfYvludWGada1d6etF_P4_zTuJsS72FkaMtm_TVvUvJd.g4Yk8j2GnpNE4wBB?startTime=1695742002000
Passcode: OJ6Ycht?



Configuration Survey Respondent Characteristics

328 configuration responses as of 22 September – remains open
95 demonstration responses as of 22 September - closed

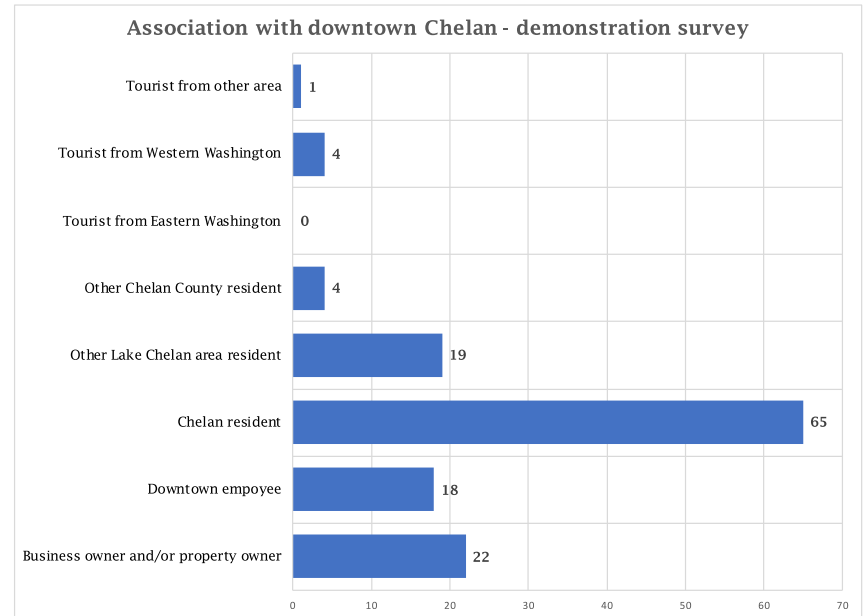
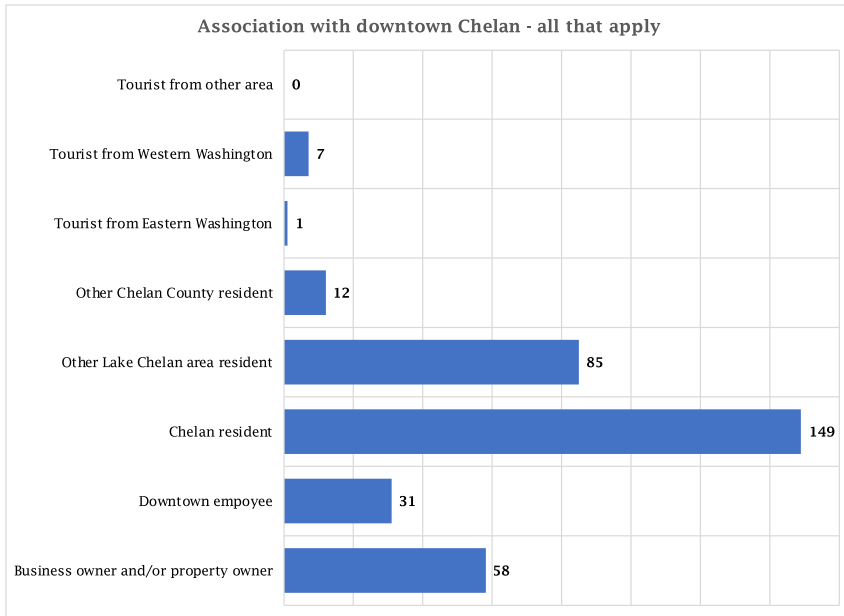

112 suggestions or recommendations from configuration survey
43 suggestions or recommendations from demonstration survey

Times frequent downtown Chelan a year

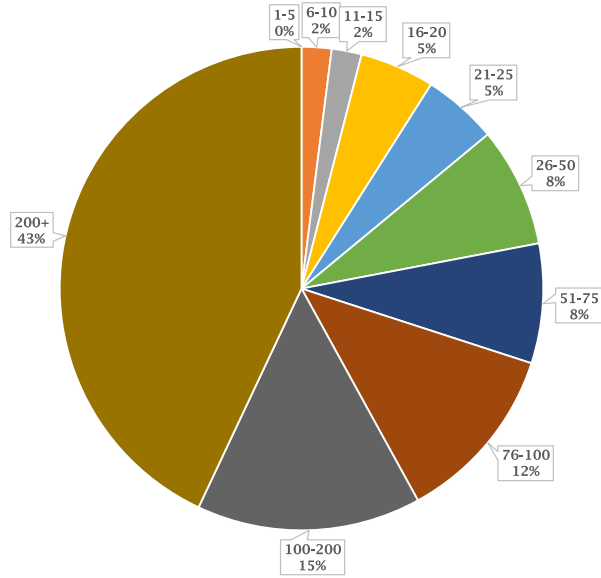

Times frequent downtown Chelan - demonstration survey

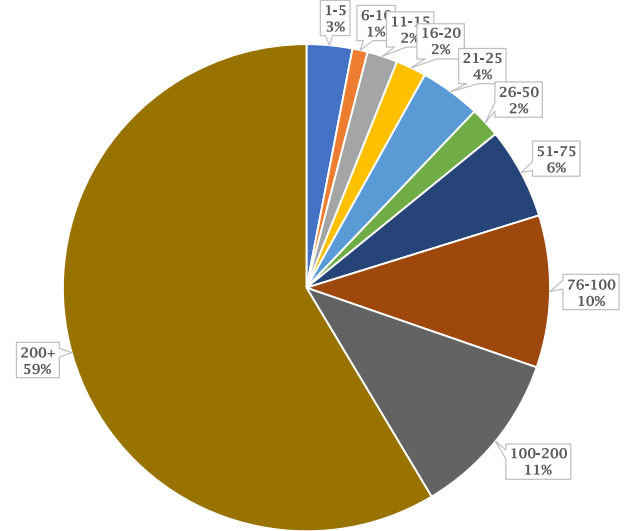

Age group of survey respondents

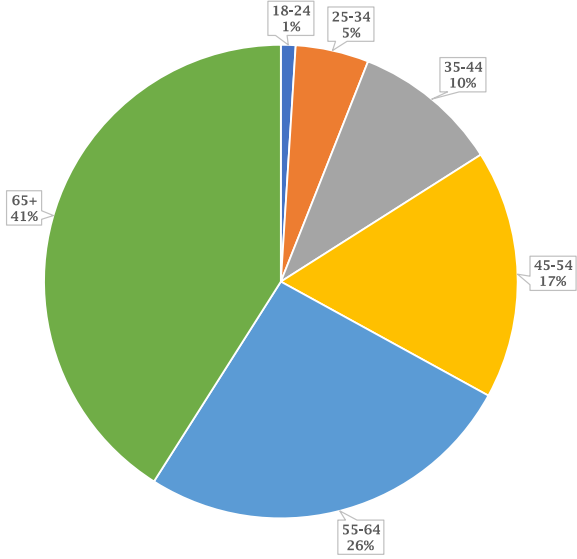

Age group - demonstration survey

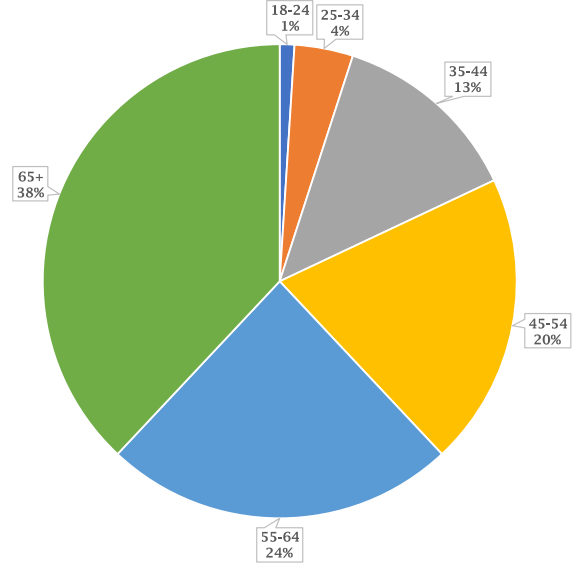

Woodin-Emerson streetscape configurations

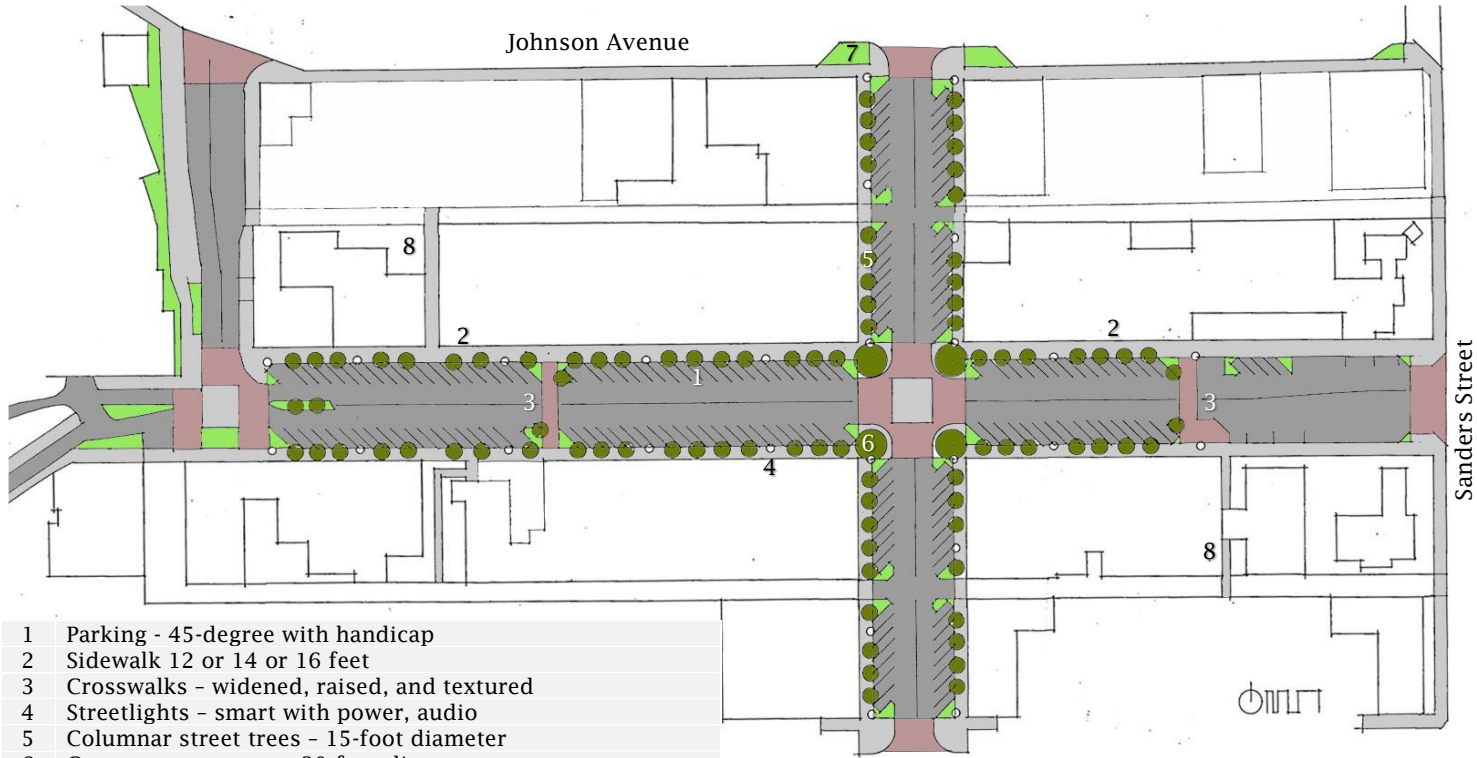

- 1 Parking - 45-degree with handicap
 - 2 Sidewalk 12 or 14 or 16 feet
 - 3 Crosswalks - widened, raised, and textured
 - 4 Streetlights - smart with power, audio
 - 5 Columnar street trees - 15-foot diameter
 - 6 Canopy street trees - 30-foot diameter
 - 7 Vegetation planter beds
 - 8 Downtown/parking lot connections
- Parking capacities
- Emerson existing - 54
 - Emerson proposed - 49 at 10', 51 at 9.5', 54 at 9'
 - Woodin existing - 117 (w/2 HC)
 - Woodin proposed - 116 at 10', 122 at 9.5', 129 at 9' w/2 HC

Install new power and audio for streetlights.	3.73
Install new irrigation system for street trees.	3.58
Align all on-street parking stalls at 45-degree for safety and visibility.	3.58
Install a crosswalk from the south parking lot at Wells Fargo Bank.	2.88



Replace existing street trees with 15-foot diameter columnar trees to grow above the awnings. 3.32

Install 30-foot diameter canopy trees at intersections for shade and heat relief. 3.31

Replace streetlights with smart standards with LED fixtures, hooded overhead light contours, and audio and other optional services. 3.75

Woodin Avenue 12-foot with and w/o median

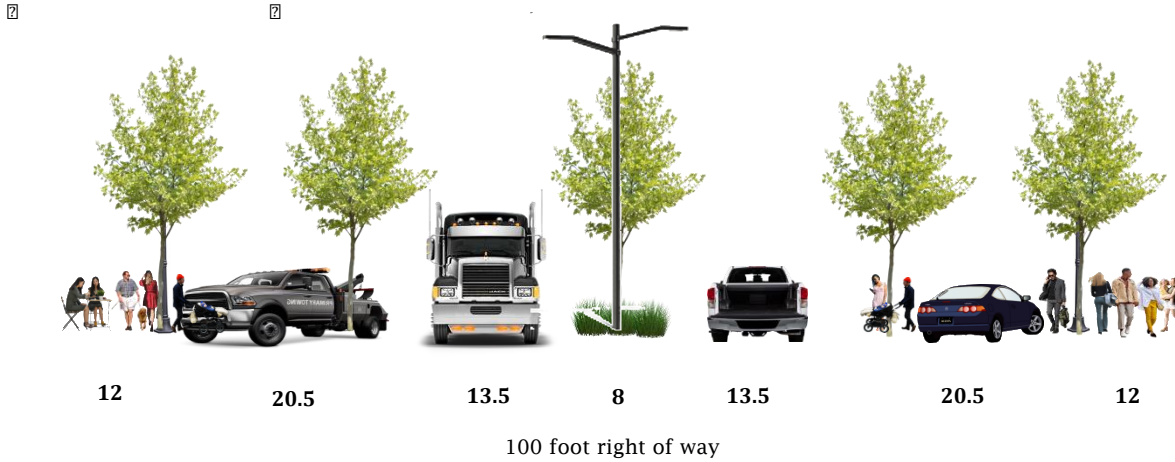

Woodin Avenue 12-foot sidewalk option with median

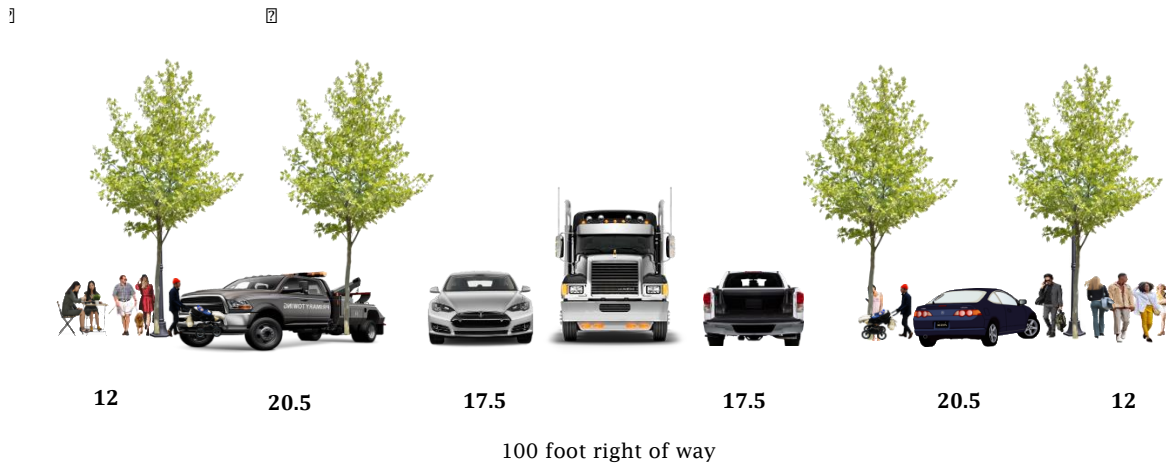

Woodin Avenue 12-foot sidewalk option with truck load

Install a landscape median between the traffic aisles and eliminate on-street truck load.	1.60
Keep right-of-way configuration as is with continued use of the space between the moving traffic lanes for on-street truck load, snow storage, and emergency vehicle access.	4.26

Woodin Avenue w/14- and 16-foot sidewalk

?

?



100 foot right of way

Woodin Avenue 14-foot sidewalk option with truck load

?

?

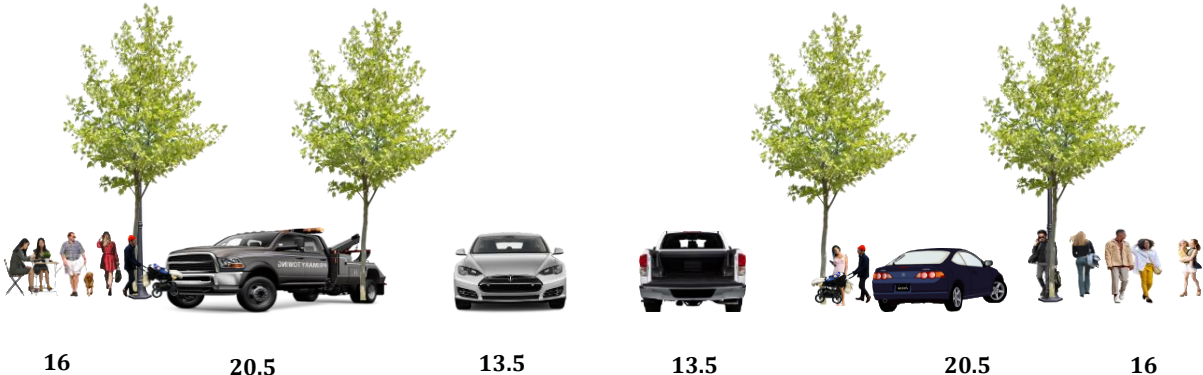

100 foot right of way

Expand sidewalk to 14 feet and retain on-street beverage truck off-loading.	3.23
Expand sidewalk to 16 feet and eliminate on-street beverage truck off-loading.	1.65

Chelan Municipal Code (CMC)

Outdoor cafes

- Sidewalk must have a minimum of 10 feet, **business use limited to 5 feet from the building**
- Minimum pedestrian right-of-way is **not less than 44 inches in** width and runs the entire width of the building frontage
- Barrier for liquor consumption must be 42 inches high
- Licenses expire at the end of every year

Awnings on Woodin Avenue

- Weather protection at least 6 feet deep (**no maximum**) for at least 70% of the façade on north side – no requirement on the south side

Sandwich Boards

- Placed adjacent to the curb
- During business hours only

At least 2 amenities per 100 linear feet of frontage

- Seating, landscaping, bike racks, kiosks, artwork, decorative clocks, special lighting, tree grates, special paving, or other

Façade details toolbox options (some examples) per 120 linear feet

- Roll-up windows or doors
- Custom weather protection such as steel canopy, cloth awning, retractable awning

12, 14, and 16-foot sidewalk capacities w/o cafes



Woodin Avenue 12-foot sidewalk option



Woodin Avenue 14-foot sidewalk option



Woodin Avenue 16-foot sidewalk option

Retain 12-foot sidewalk for 3 passersby.	3.32
Expand sidewalk to 14 feet to accommodate 4 passersby.	2.94
Expand sidewalk to 16 feet to accommodate 5 passersby,	1.65

12-foot sidewalk with outdoor café options

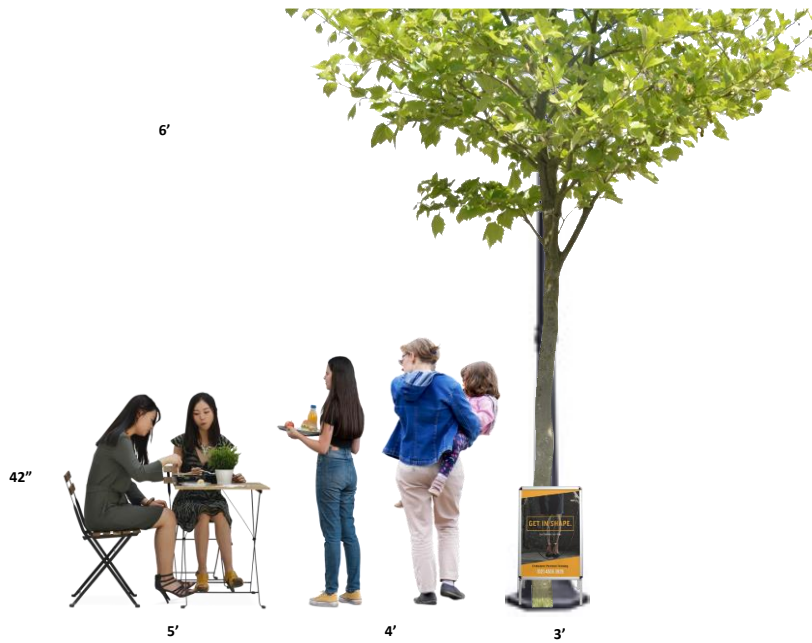

Woodin Avenue 12-foot sidewalk w/outdoor café option



Woodin Avenue 12-foot sidewalk w/in/outdoor café option

Continue to allow outdoor cafes to extend 5 feet into the sidewalk reducing walkway width to 44 inches or 1 passersby with waitstaff.	2.84
Amend CMC to restrict outdoor cafes to 2 feet and allow use of bifold or rollup doors for indoor/outdoor access and internal waitstaff services.	3.01

14 and 16-foot sidewalk with outdoor café



Woodin Avenue 14-foot sidewalk w/outdoor café option



Woodin Avenue 16-foot sidewalk w/outdoor café option

Expand the sidewalk to 14 feet and possibly continue to allow outdoor cafes to extend 5 feet into the sidewalk.	3.01
Expand the sidewalk to 16 feet and possibly continue to allow outdoor cafes to extend 5 feet into the sidewalk.	1.82

Downtown demonstrations

Parking stalls widths

10-foot stall widths	3.08
9.5-foot stall widths	3.46
9-foot stall widths	1.98

Sidewalk widths

12-foot sidewalk width (existing) with 17.5-foot traffic aisles in each direction	3.23
14-foot sidewalk width with 15.5-foot traffic aisles in each direction	3.03
16-foot sidewalk with 13.5-foot traffic aisles in each direction and no in-street truck off-loading	1.86

Crosswalk

Crosswalk proposal from south parking lot at Wells Fargo Bank	2.63
---	------

Consultant Pro/Con Comparisons

Alternatives	Pro	Con
12-foot sidewalk	Least disruptive Least expensive	Outdoor café intrusions into walkway must be cutback as do awning extensions into street trees to maintain/restore pedestrian capacity
14-foot sidewalk	Increases walkway capacity without cutting back outdoor cafes or awnings Still allows truck deliveries and snow storage	Reduces traffic aisles by 4 feet More expensive
16-foot sidewalk	Increases walkway capacity without cutting back outdoor cafes or awnings	Reduces traffic aisles by 8 feet eliminating center road truck delivery and reducing snow storage capacity Most expensive

Plaza – north parking lot

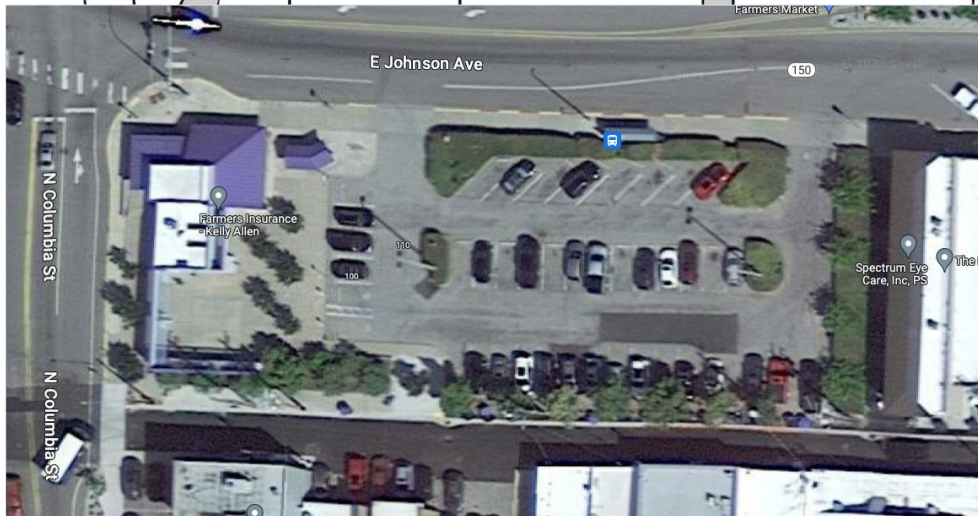
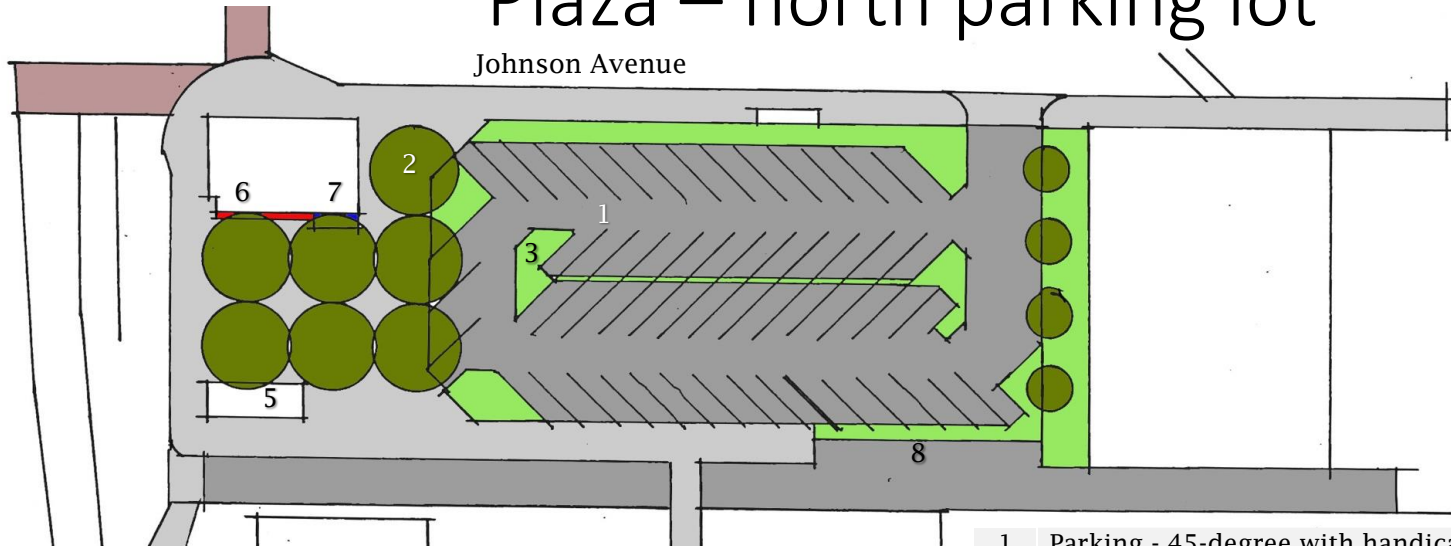

- | | |
|---|--|
| 1 | Parking - 45-degree with handicap |
| 2 | Canopy street trees - 30-foot diameter |
| 3 | Vegetation planter beds |
| 4 | Downtown/parking lot connections |
| 5 | Unisex restroom - 2 family, 2 individual |
| 6 | Bulletin/directory board |
| 7 | Covered bike rack |
| 8 | Trash bin corral |
| Parking capacity | |
| Existing - 42 stalls w/2 HC | |
| Proposed - 56 at 10', 59 at 9.5', 62 at 9' w/2 HC | |

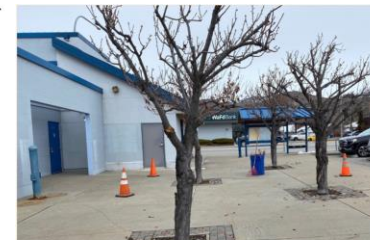

Reconfigure the parking lot to provide one-way 45-degree stalls with a single entry/access. 3.66

Demolish the existing gang-style restrooms and replace with unisex, restrooms, shade trees, new bulletin/directory, bike rack, and seating furniture. 3.19

South parking lot

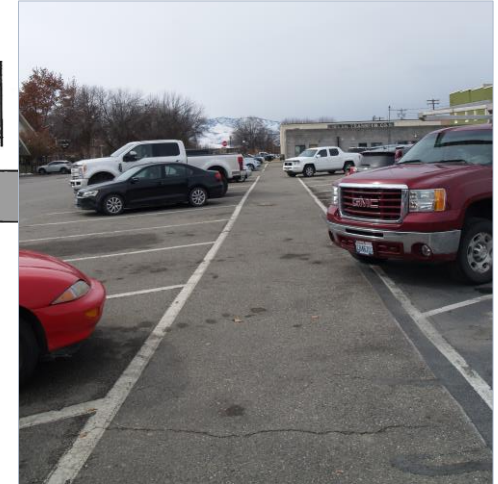
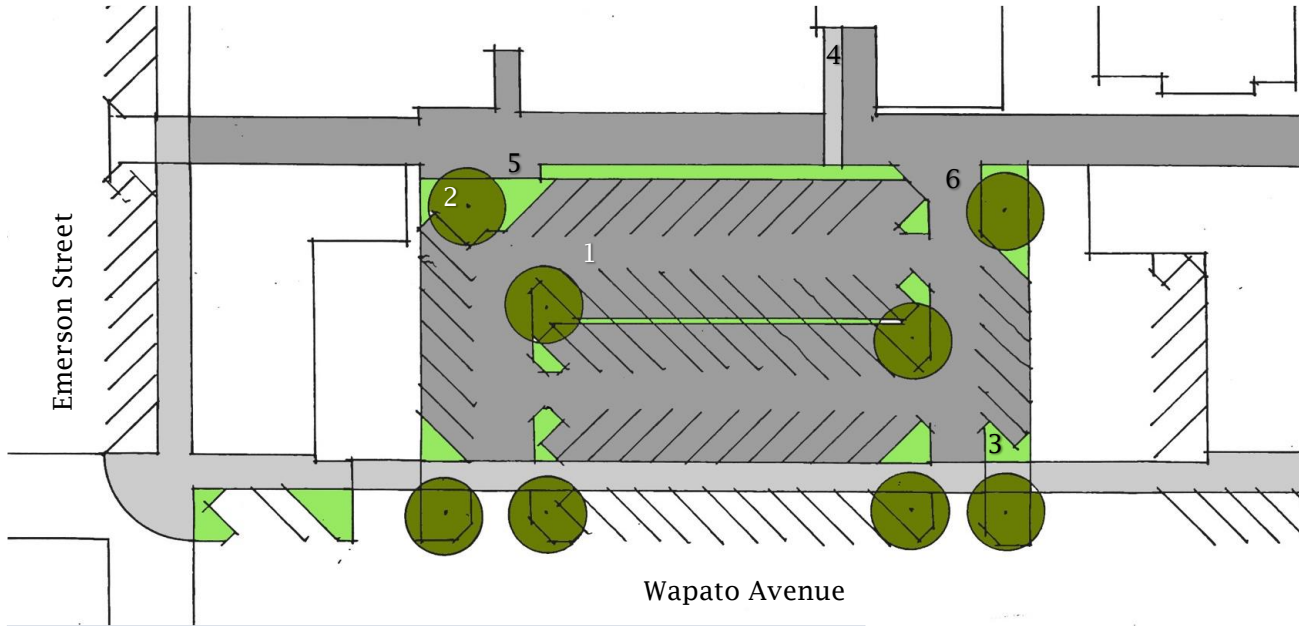

- 1 Parking - 45-degree with
- 2 Canopy street trees - 3
- 3 Vegetation planter beds

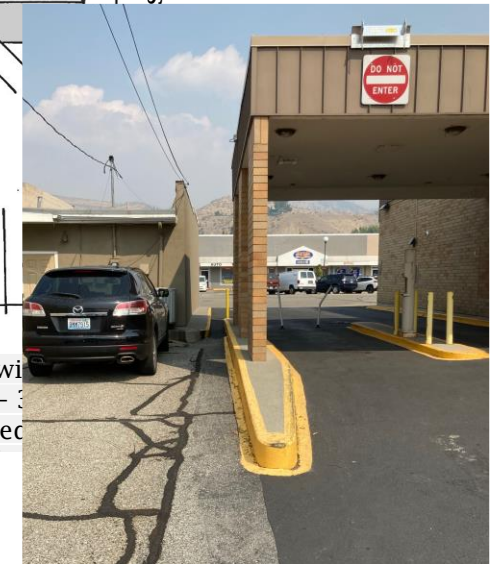

Reconfigure parking lot to provide 2 entry/exits, 45-degree parking stalls, sidewalks, canopy trees and landscaped islands. 3.40

Work with Wells Fargo Bank to relocate the ATM to the drive-through aisle and expand the bumper strip along the west wall of the property to 6-feet to access the crosswalk across Woodin. 3.36

Riverwalk Park – Farmers’/Art Markets

Woodin Avenue

Emerson Street

Wapato Ave

- 1 Vendor stalls 10x10 foot - 58 stalls
- 2 Food trucks - 2 trucks
- 3 Vendor parking stalls



Farmers’/Art Market stalls and walkway

Relocate Farmers’ Market vendors into Riverwalk Park using frontage along Wapato and Emerson and the existing plaza at the PUD’s covered picnic facility. Return Emerson to a through-street during the Market for customer parking.

3.55

Preliminary costs

Alternatives	12-foot	14-foot	16-foot
Woodin+Emerson streetscape	\$4,382,758	\$4,616,422	\$4,692,156
North parking lot	\$37,427	\$37,427	\$37,427
South parking lot	\$164,957	\$164,957	\$164,957
Plaza	\$373,450	\$373,450	\$373,450
Riverwalk Park Farmers'/Art Mkts	\$28,010	\$28,010	\$28,010
Total	\$4,986,602	\$5,220,266	\$5,296,000

A stylized graphic featuring a white bridge with a series of pillars and arches receding into the distance. Above the bridge, a series of yellow rays radiate outwards, resembling a sunburst. The entire graphic is set against a solid green background.

Questions?

IMAGINE

DOWNTOWN CHELAN